

Condensation forming on the underside of a single skinned skylight sheet is due to internal warm moist air meeting with a cold skylight surface and can diminish the benefits derived from installing skylights.

Ampelite's DripGuard provides a second translucent sheet which acts as a barrier to catch the drips of water from the underside of the top sheet, which then flows away down to the buildings gutter. Schools, sport stadiums and multi-purpose buildings have been quick to embrace Ampelite DripGuard to solve the problem of condensation. Condensation is fully controlled and eliminated.

AMPELITE'S DripGuard has been specifically designed for the New Zealand climate providing natural daylight, simplicity and ease of installation and long-term condensation control for years to come.

DripGuard LR (low rib) uses 2 sheets of the same profile with a spacer between the middle of the sheets to create an air gap which allows condensation to drip down onto the bottom sheet.

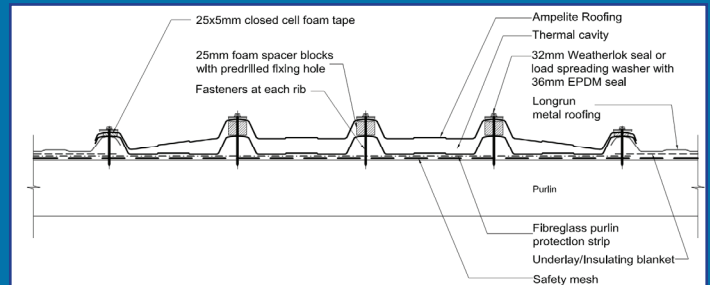

DripGuard LR is compatible with most current roofing profiles such as Corrugated, Sixrib, 5rib, Styleline, Veedek, Plumbdek, Trimline, MC700, MC750, MC770, Metric, Windek, MC1000, Ribline 960, LT7.

DripGuard HR (high rib) is designed to be easily installed with most commercial roofing profiles. Two fibreglass roofing sheets of differing profile heights are installed one on top of the other creating an air gap which allows condensation to drip down onto the bottom sheet.

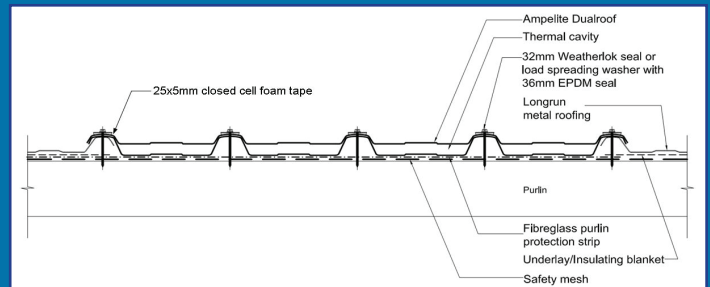

DripGuard HR is compatible with most current commercial roofing profiles such as DP955, BB900, Steelspan, Topspan, Multispan, ST900, Maxispan and MC930, Multi Rib and ST963.

Wonderglas S-996 or Cool-lite IR Top Sheet

Ampelite's Wonderglas S-996, used widely throughout New Zealand and Australia since 1995 is utilised as the top sheet and can be supplied in either clear or opal. Cool-lite IR Solar control sheeting can be used where lower heat transmission is required. Where skylights need to withstand foot traffic, use our Webglas GC trafficable fibreglass sheeting.

■ LIGHT & HEAT TRANSMISSION (1800gsm / 1.1mm)

Clear		Opal	
Light	Heat	Light	Heat
62%	60%	47%	44%

■ AVAILABLE COLOURS & PROFILES

The DripGuard system is available with a Clear or Opal top sheet and a clear bottom sheet. Other colours can be produced to order for viable quantities.

For information regarding light and heat transmission when using Cool-lite IR as a topsheet, please contact your local Ampelite office.

■ SHEETING GRADES & THICKNESS

Series	Weight (Kg/m ²)	Thickness
1800	1.80	1.1mm
2400	2.40	1.4mm
3050	3.05	1.7mm
3660	3.66	2.0mm
4270	4.27	2.3mm
4880	4.88	2.6mm

■ EXPANSION DATA

*Materials expansion comparison.
0° to 40° temperature variation.
Sheet lengths - 6 metres.*

Material	Thermal Expansion	Thermal Co-efficient
Fibreglass	7.2mm	3.0 x 10 ⁻⁵ cm/cm°C
Polycarbonate	16.2mm	6.75 x 10 ⁻⁵
Steel	2.9mm	1.2 x 10 ⁻⁵ cm/cm°C
Aluminium	5.8mm	2.4 x 10 ⁻⁵ cm/cm°C

■ ACCESSORIES

Ampelite has a large range of accessories available to help make the installation of our DripGuard fast and professional. These accessories include our range of Ampelok self-drilling screws which oversize the fastener holes as they pass through the sheet, self-adhesive tapes and profiled foam sealing strips for vermin protection.

■ WARRANTY

Ampelite DripGuard features a 25 year warranty. For more information contact your nearest Ampelite office.

■ SPANNING (1.5 KPA) - DRIPGUARD LR

Profile	1.1mm	1.4mm
Corrugated	1000mm	1200mm
Sixrib	1000mm	1200mm
5 Rib	1200mm	1500mm
Trimline	1200mm	1500mm
MC700,750,770	1200mm	1500mm
Metric, Windek, MC1000	1200mm	1500mm
Ribline 960	1200mm	1500mm
LT7, ST7, Silbery 7	1400mm	1700mm

■ SPANNING (1.5 KPA) - DRIPGUARD HR

Profile	1.1mm	1.4mm
BB900, ST900, ST9630, Multi Rib	1400mm	1700mm
Steelspan, Topspan,	1600mm	1800mm
Multi Span, MC930, Maxispan	1600mm	1800mm

■ PHYSICAL PROPERTIES

Tensile Strength	80 Mpa
Impact Strength	8 Joules
Shear Strength	90 Mpa
Modulus of Elasticity	5500 Mpa
Compressive Strength	135 Mpa
Specific Gravity	1.45
Thermal Expansion	3.0 x 10 ⁻⁵ cm/cm°C
Water Absorption	0.2% in 24hrs/26°
Recommended Service Temperature Range	-20° to +95°C



Freephone: 0800 AMPELITE
(0800 267 354)
www.ampelite.co.nz

AMPELITE
makes light work!